

360°

EMITTING NEON

NCR23A

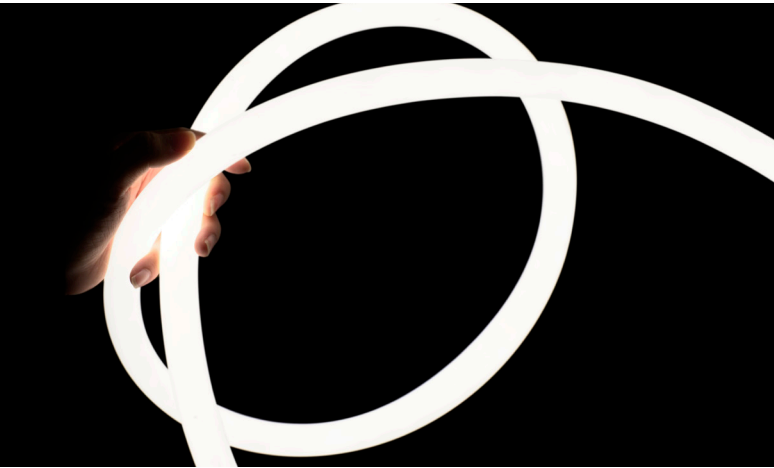



Features

- Color options: single color.
- Short cutting design, arbitrary cutting without large dark areas.
- 360° light-emitting with good flexibility.
- Warranty: 5 years indoor
- Single color supports PWM, 0-10V, DALI and DMX dimming.

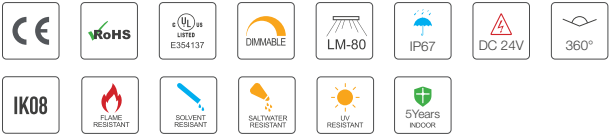

Optical & Electrical Parameters

Model No.	Voltage	Ra	Color	Lm/m	Lm/W	W/m
NCR23A-Single color	24V DC	>90	2500K	1040	65	16.0
			2700K	1072	67	
			3000K	1088	68	
			3500K	1120	70	
			4500K	1088	68	
			5500K	1104	69	

Model No.	LED QTY (pcs/m)	Standard Run	Min. Cuttable Length	Working Temperature	Storage Temperature
NCR23A-Single color	336	5.0 m	5.95 mm	-20~+60°C	-20~+70°C

Profile Drawings

Unit:mm[inch]

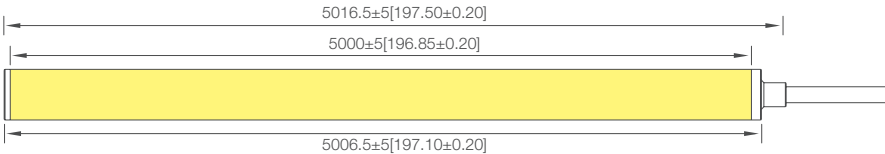

Bend direction

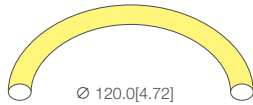

Sectional view

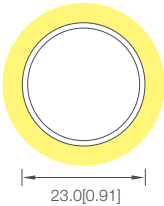

Front cap

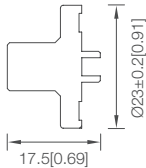

Closing-end cap

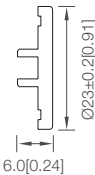

Note: More info, please contact sales rep.

Luminous Intensity Distribution Diagram

Average Illumination

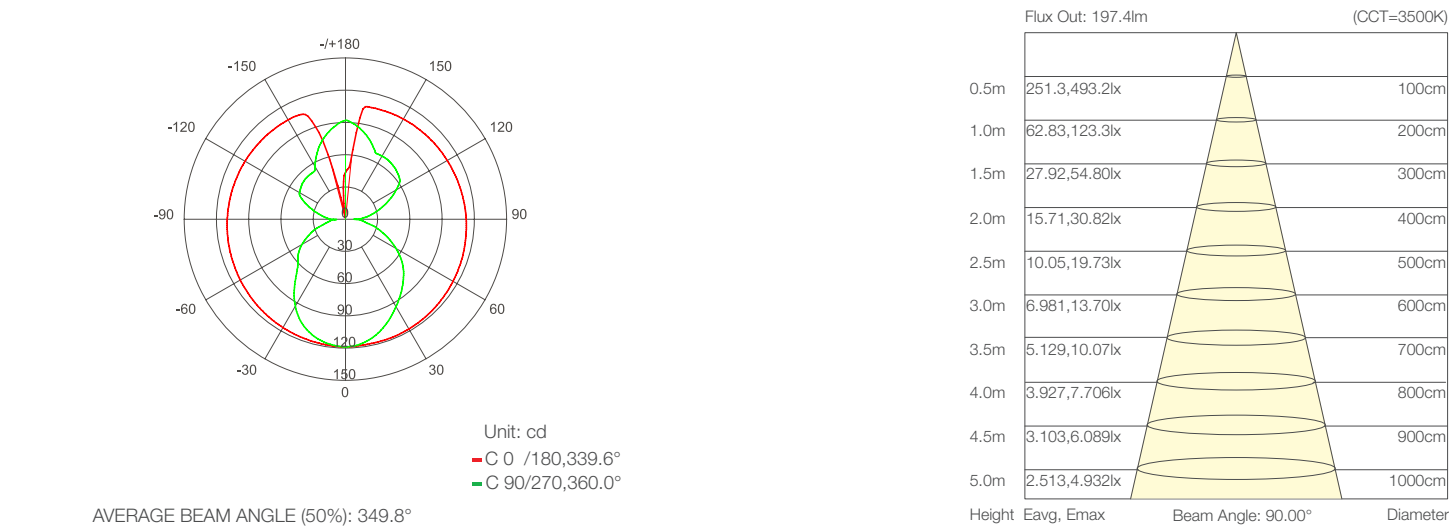

Note: The above two pictures are tested with the sample NCR23A at 3500K. For more info, please contact sales rep.

Recommended power supply upon working length

NCR23A-Single color

Working Length	Measured Current	Rated Voltage	Measured Power	Recommended Power Supply	Power Supply Mode
1m	0.66 A	24V DC	15.84 W	25 W	Single Feed
5m	2.68 A	24V DC	64.32 W	80 W	Single Feed

Products and Tools





LED power supply

Electric drill

Controller (optional)

Installation method

Picture	Name	Model	Order number	Quantity(5m)	Free/Optional
	Ceiling Kit - hardware set	ASY-NCR23A-SC1NN1000-MT	01.06.PJ21011401	\	Optional
	Ceiling Kit - hardware and PC tube set	ASY-NCR23A-SC2NN1000-MT	01.06.PJ21011403	\	Optional

Picture	Name	Model	Order number	Quantity(5m)	Free/Optional
	Pendant Kit - hardware and PC tube set	ASY-NCR23A-SP4NN1000-MT	01.06.PJ21011404	\	Optional
	Pendant Kit - output wire two in one	ASY-NCR23A-SP3NN1000-MT	01.06.PJ21011402	\	Optional
	Pendant Horizontal Kit - hardware and PC tube set	ASY-NCR23A-SPPNN1000-MT	01.06.PJ21012801	\	Optional
	Hardware end-cap set	ASY-NCR23A-S00NNX-EC	01.06.PJ21011405	\	Optional

Product accessories

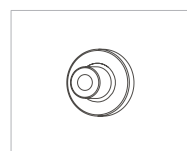

ASY-NCR23A-N00NNH-EC

Item: Front cap
Order number: 01.06.KL20060301
Quantity(5m): 1pcs
Free/Optional: Optional

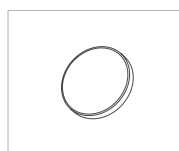

ASY-NCR23A-N00NNX-EC

Item: Closing End-cap
Order number: 01.06.KL20060302
Quantity(5m): 1pcs
Free/Optional: Optional



ASY-NCR23A-P2NN0015-MT

Item: Plastic clip
Order number: 01.06.JS20070106
Quantity(5m): 10pcs
Free/Optional: Optional

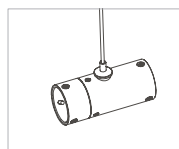

ASY-NCR23A-C1NN1000-MT

Item: Splicing set
Order number: 01.06.PJ20121505
Quantity(5m): 5pcs
Free/Optional: Optional



ASY-NCR23A-SP2NN1000-MT

Item: Pendant kit (hook + steel cable)
Order number: 01.06.PJ20121501
Quantity(5m): 15pcs
Free/Optional: Optional

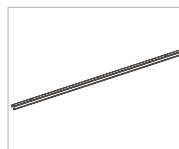

ASY-NCR23A-P3NN1000-MT

Item: PC Groove (Ceiling)
Order number: 01.06.PJ20121504
Quantity(5m): 5pcs
Free/Optional: Optional

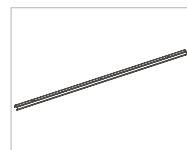

ASY-NCR23A-P4NN1000-MT

Item: PC Groove (Pendant)
Order number: 01.06.PJ20121503
Quantity(5m): 5pcs
Free/Optional: Optional



WR-7516

Item: Silicone Glue
Order number: 01.10.0220000418
Quantity(5m): --
Free/Optional: Optional

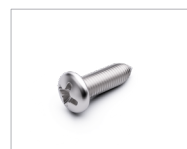

PA3

Item: Screws
Order number: --
Quantity(5m): 30pcs
Free/Optional: Optional

Profile Drawings (neon + installation accessories)

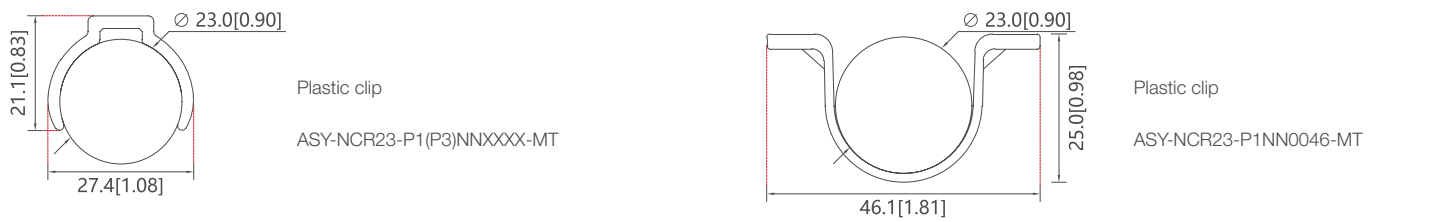

Installation

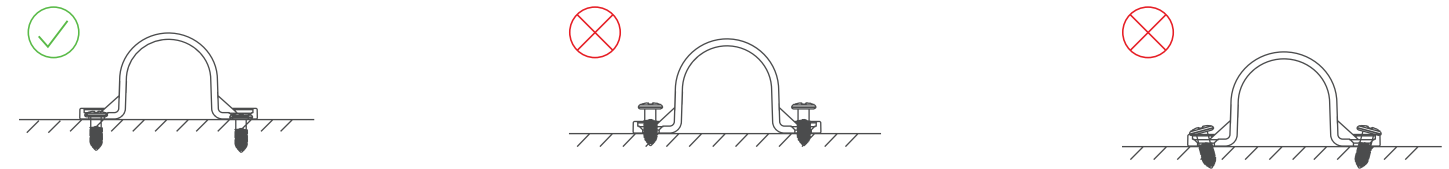
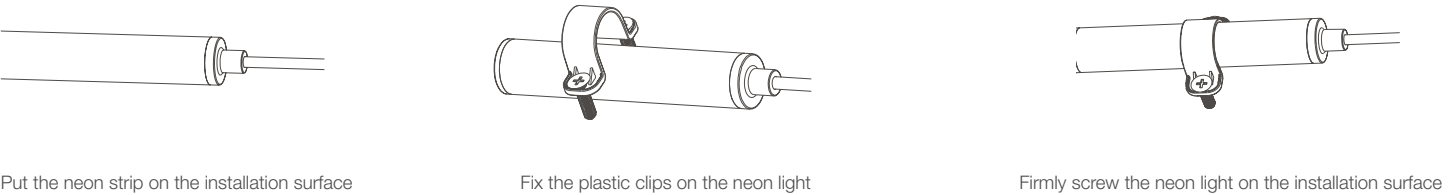

- Notes:
- The screws must be vertical to the mounting surface and be fastened, as shown in the figure on the right;
 - Please choose suitable operation steps according to the actual needs;
 - During mounting, please pay attention to the min bending diameter, and best to use original factory accessories;
 - More information, please feel free to consult us;

Packaging Information

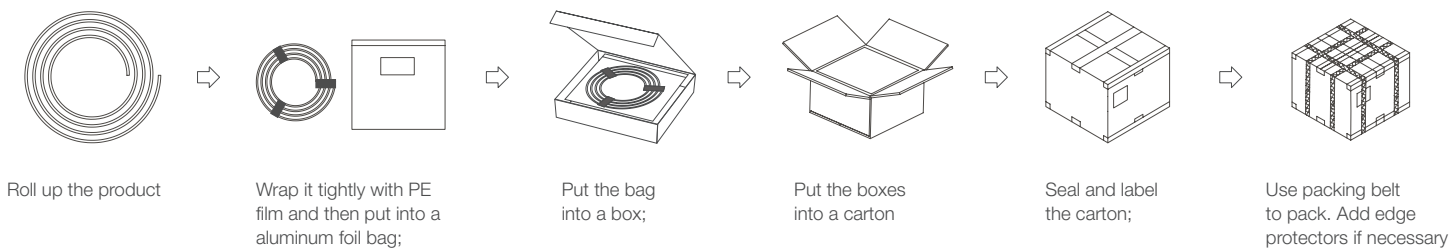

Packaging information

Model No.	Product Size L*W*H (mm)	Carton Size (mm)	Meter/Reel	Reel/Carton	Gross Weight (kg)
NCR23A	5000*23*23	480*445*370	5	6	15.35(1± 10%)

- For other customized length packaging, please ask our sales rep.
- The above-mentioned packaging quantity and weight are only for the illustrated packaging method. For other packaging methods, the packaging quantity and weight will be different. The actual weight is subject to the actual product.

Warning Mark

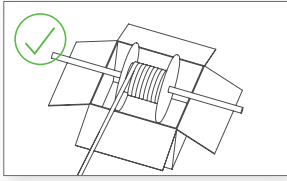

Insert a stick on the reel and place it on the packing box, and rotate the reel to get the product.

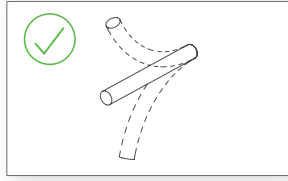

Top bending

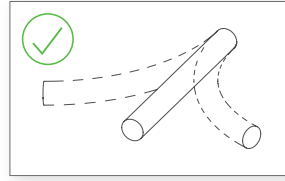

Side bending

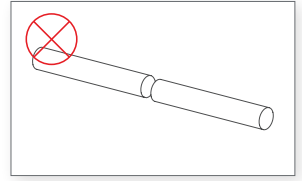

Do not make cuts.

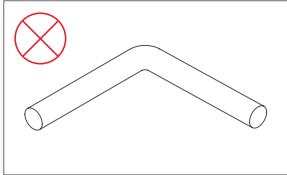

Do not bend at right angles

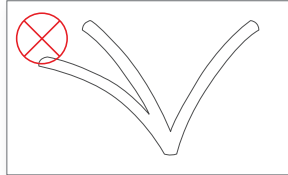

Do not bend many times, for it can endanger electronic lines.

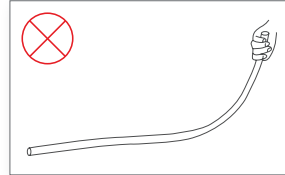

Do not throw or pull when taking products

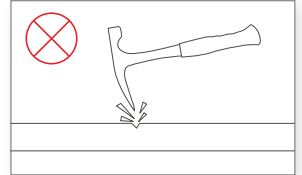

Avoid touching sharp objects

Note: Please pay attention to above warnings when using;

Warning

- Do not disassemble or retrofit the light. Do not touch the surface of the light with a sharp object.
- Do not do live-line working during installation, especially for high voltage product.
- Do not use any organic chemical solvents.
- Use neutral glass adhesive to fix this product and it needs to be dried 4 hours in the open environment after operation.
- Treat the ends and the circuit connection points that are not connected to the main line with insulation, waterproof, and anti-corrosion in the installation.
- Use 18AWG (0.75mm² cross-sectional area) or thicker core wire to avoid adverse consequences caused by overheating, if the power cable need to lengthen.
- Make sure the input voltage meets the requirements and lines are connected correctly before lighting on
- This product is for signage, and do not use as general lighting.
- Series connection within the max run.
- The length of the power cable between the power supply and the led strip should not exceed 2 meters. Otherwise, large circuit loss will lead to inconsistent brightness.
- Installation, maintenance and repair should be operated by a qualified technician.

Attentions before installation

- Before installation, check that the product parameters are consistent with the requirements (Seeing product specifications or product labels)
- Load voltage, current, power and power supply should be matched with the product.
- Follow the instructions of wiring diagram (first connect the load and then the power supply) to avoid short circuit
- Make sure the correct connection of positive and negative poles between products and power supply. Otherwise, the light will not be on.
- Make sure the power cord firmly screwed into the terminal and it should not be pulled out by hands.
- The terminal should have waterproof and anti-corrosive treatment.

Statements and Recycling

Packaging information

- Repair should be operated by a qualified technician or supplier, if the external circuit or main line of this product is damaged.
- The parameters given in this manual are typical values and for reference only
- All illustrations and drawings in this manual are for reference.
- This product is subject to change without notice.

Recycling

- LED lighting products belongs to electronic products, please do recycling treatment according to the relevant WEEE directives.

Version	Content	Date
A1.0	First Release	2024-1-15

BLUEVIEW ELEC-OPTIC TECH CO.,LTD

☐ Tel: +86-28-8148 0011

☐ Web.: www.blueviewled.com

☐ Add.: No. 1000, Section 2, Konggang 2nd Road, Shuangliu, Chengdu 610207, Sichuan, CHINA

☐ Fax: +86-28-8148 1258

☐ Email: sales@blueviewled.com