



**LED**

**STRIP LIGHT**

**DC 12/24V**

S-type Strip

**SXX-2835C**

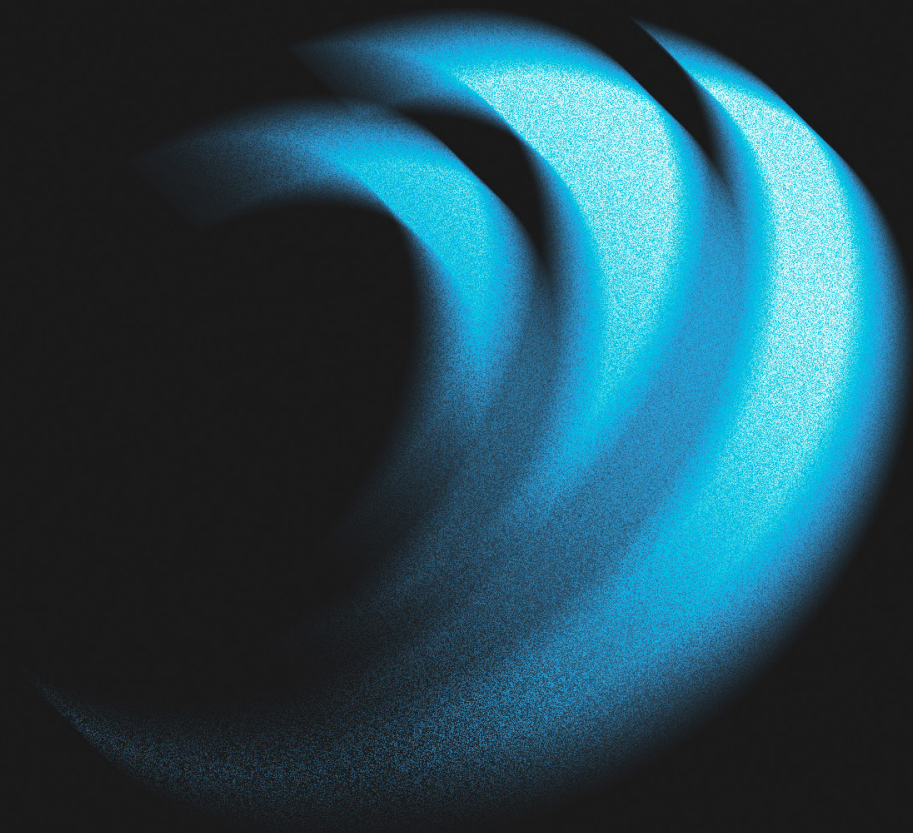



# SXX-2835C-120-XX

S-type Strip

## FEATURES

- 120LEDs/m high-density, mini PCB width.
- Every 3/6LEDs cuttable, with good flexibility



120°



2835



12/24V



3Years



IP20











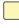

IP54

## DIMENSION











Input voltage: 12/24V	Tape IP: IP20/IP54
CRI: >80	Warranty: 3years
Rated power: 7.2W	Working temperature: -20~+60°C
Power error range: ±10%	Storage temperature: -20~+70°C

## OPTICAL & ELECTRICAL PARAMETERS

 | Non-Waterproof(N)

Model No.	Voltage	CRI	Color	CCT/Wavelength	Lm/m	Lm/W	W/m
SN-2835C-120-12/24-W	12/24V DC	>80	W	 2700K	680	95	7.2
				 3000K	720	100	
				 4500K	775	108	
				 6500K	775	108	
				 11000K	720	100	
SN-2835C-120-12/24-R	12/24V DC	\	R	 620-630nm	215	30	7.2
SN-2835C-120-12/24-G			G	 515-525nm	500	70	
SN-2835C-120-12/24-B			B	 465-470nm	158	22	
SN-2835C-120-12/24-Y			Y	 1700K	575	80	
SN-2835C-120-12/24-O			O	 600-605nm	230	32	

 | Spray Glue Coated(WP)

Model No.	Voltage	CRI	Color	CCT/Wavelength	Lm/m	Lm/W	W/m
SWP-2835C-120-12/24-W	12/24V DC	>80	W	 2700K	660	92	7.2
				 3000K	700	97	
				 4500K	755	105	
				 6500K	755	105	
				 12000K	700	97	
SWP-2835C-120-12/24-R	12/24V DC	\	R	 620-630nm	200	28	7.2
SWP-2835C-120-12/24-G			G	 515-525nm	490	68	
SWP-2835C-120-12/24-B			B	 465-470nm	145	20	
SWP-2835C-120-12/24-Y			Y	 1700K	560	78	
SWP-2835C-120-12/24-O			O	 600-605nm	215	30	

OTHER PARAMETERS

Model No.	LED Qty (pcs/m)	Max Run	Min. Cutting Unit	LED Pitch	Tape IP
SXX-2835C-120-12	120	1.5 m	25 mm	8.3 mm	IP20/IP54
SXX-2835C-120-24	120	2.5 m	50 mm	8.3 mm	IP20/IP54

- NOTE:
- Test environment temperature is 25±2°C.
  - The above data was measured under standard conditions and actual data may be different. We would update data without further notice.
  - The above luminous flux data is based on single-color.
  - If the selected LED chip is different, the color temperature and luminous flux will change accordingly.
  - The UL cascade data is the maximum cascade of UL Class 2 power supply 24V within 100W, with no significant brightness difference.
  - The max run data is a 10% attenuation of the standard voltage and a 20% attenuation of the current for the blue scene.

PROFILE DRAWINGS

Unit: mm [inch]

SXX-2835C-120-12-5mm

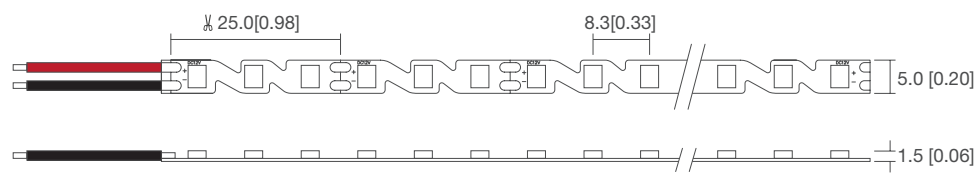

SXX-2835C-120-24-5mm

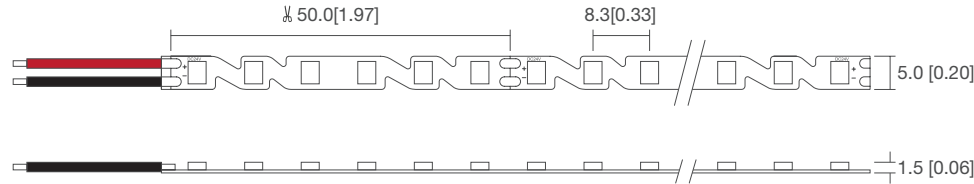

SXX-2835C-120-12-6.5mm

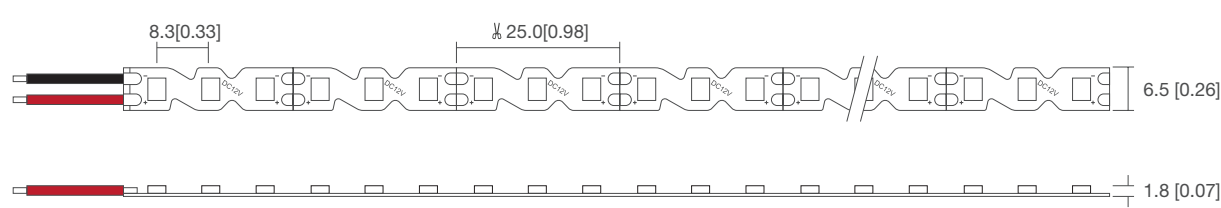

SXX-2835C-120-24-6.5mm

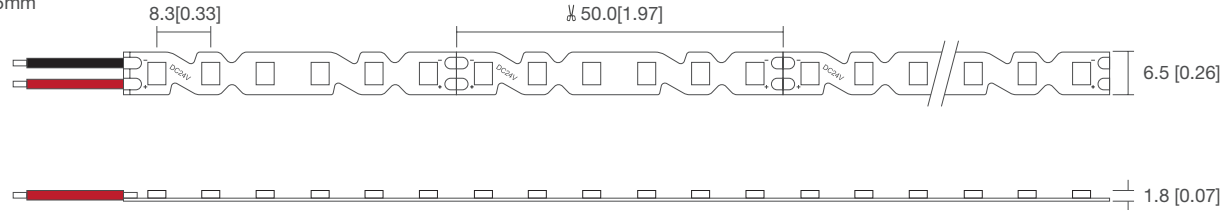

Note: for more info, please contact sales rep.

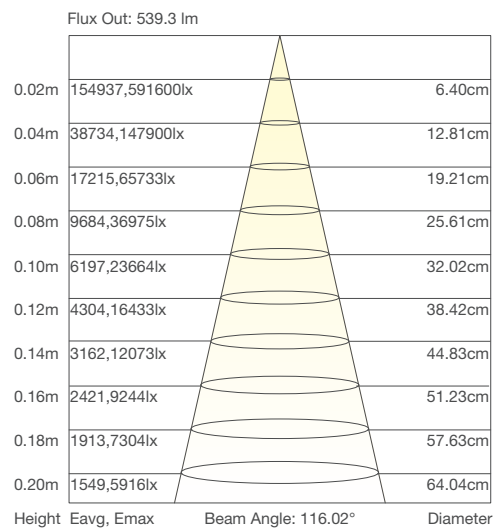
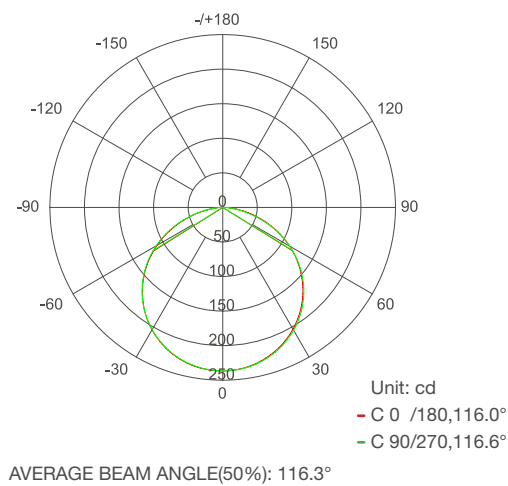

RECOMMENDED POWER SUPPLY UPON WORKING LENGTH

SXX-2835C-120-12

Operating Length (m)	1.5	2.0	3.0	4.0	5.0
Operation Voltage (DC V)	12.0	12.0	12.0	12.0	12.0
Total current (A)	0.85	1.02	1.25	1.35	1.42
Total Power (W)	10.2	12.24	15.0	16.2	17.0
Head voltage (DC V)	12.0	12.0	12.0	12.0	12.0
Tail voltage (DC V)	11.2	10.7	9.82	9.12	8.25
Head current (mA)	15.25	15.25	15.25	15.25	15.25
Tail current (mA)	12.35	10.92	7.5	5.04	3.2
Head-to-tail voltage drop rate(%)	6.7%	10.8%	18.2%	24%	31.3%
Head-to-tail current drop rate(%)	19%	28.4%	50.8%	66.8%	79%
Single/Double feed	Single feed	Double feed	Double feed	Double feed	Double feed

COLOR TEMPERATURE DISTRIBUTION MAP

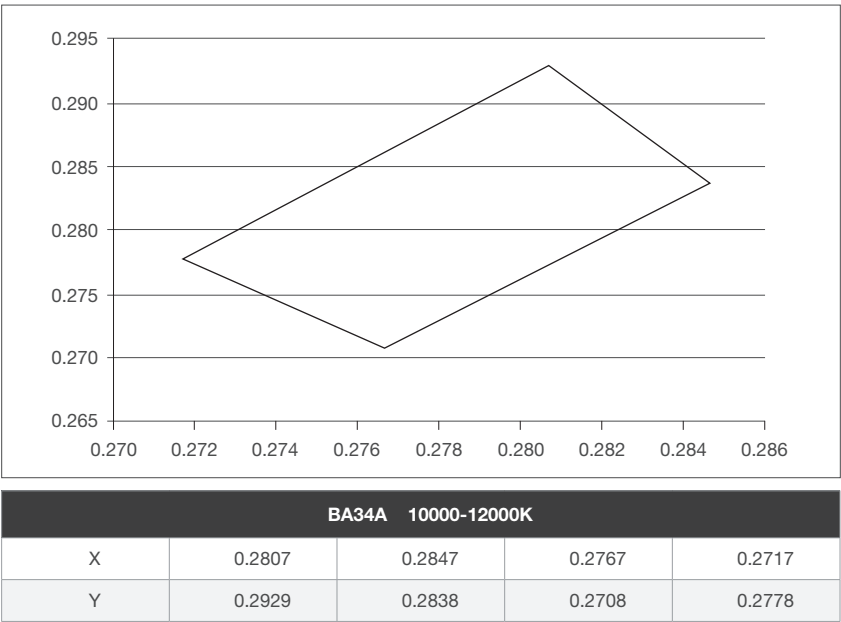

PACKAGING INFORMATION

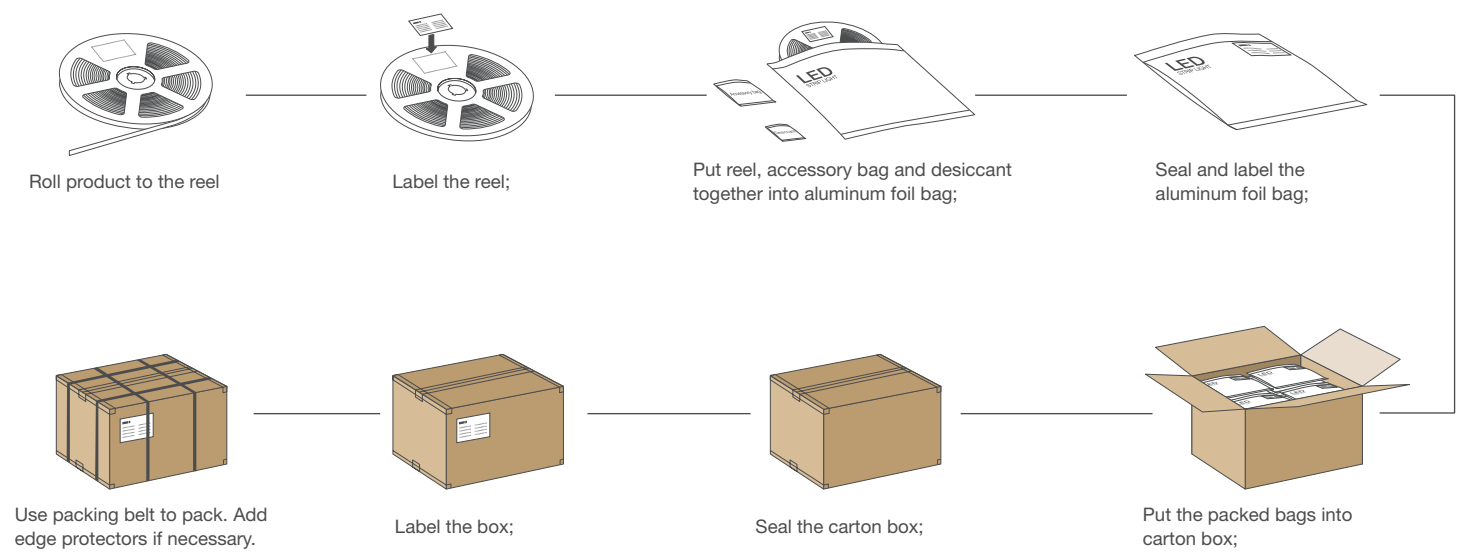

Model No.	Product Size L*W	Carton Size	Reel/Carton	Net Weight (kg)	Gross Weight (kg)
SXX-2835C-120-12/24-5mm	20000*5.0mm	570*375*285mm	140	13.72 (1±10%)	16.50 (1±10%)
SXX-2835C-120-12/24-6.5mm	20000*6.5mm	380*380*325mm	30	10.80 (1±10%)	12.85 (1±10%)

NOTE:

The above-mentioned packaging quantity and weight are only for the illustrated packaging method. For other packaging methods, the packaging quantity and weight will be different. The actual weight is subject to the actual product.

INSTALLATION TOOLS



INSTALLATION METHODS AND STEPS

Aluminum channel installation



Covered channel installation

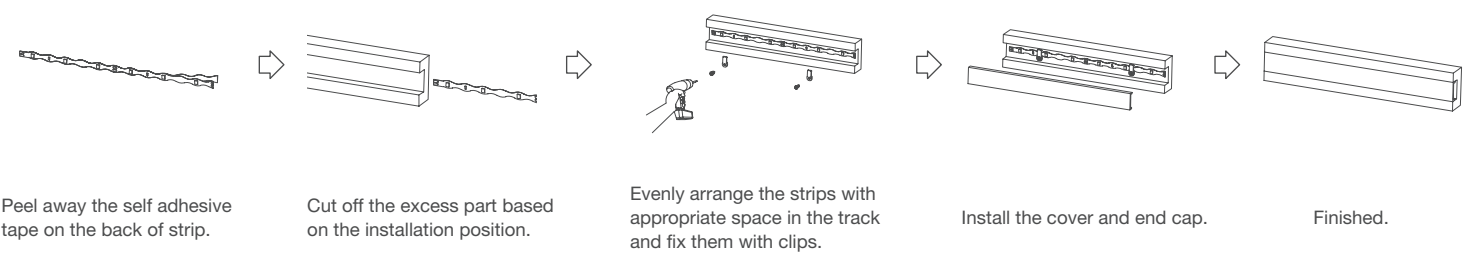

Backplate-mounted illuminated letters

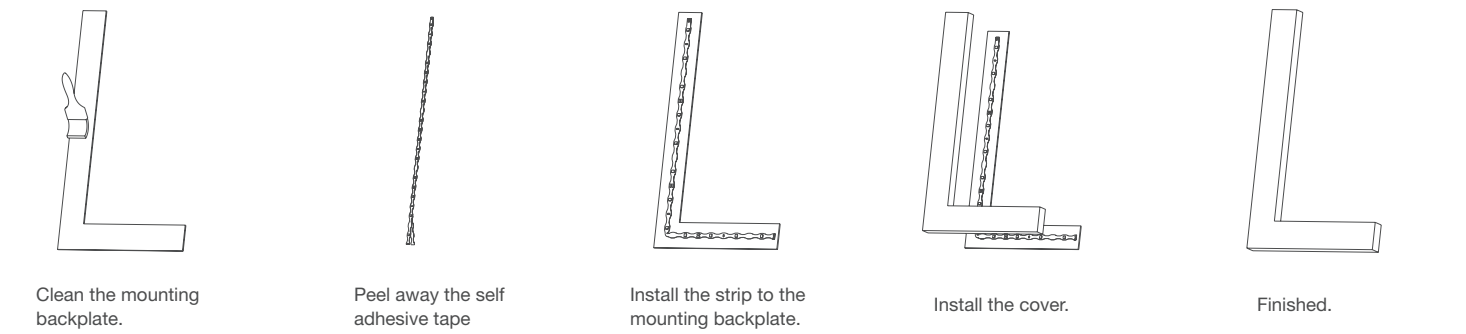

Groove-mounted illuminated letters

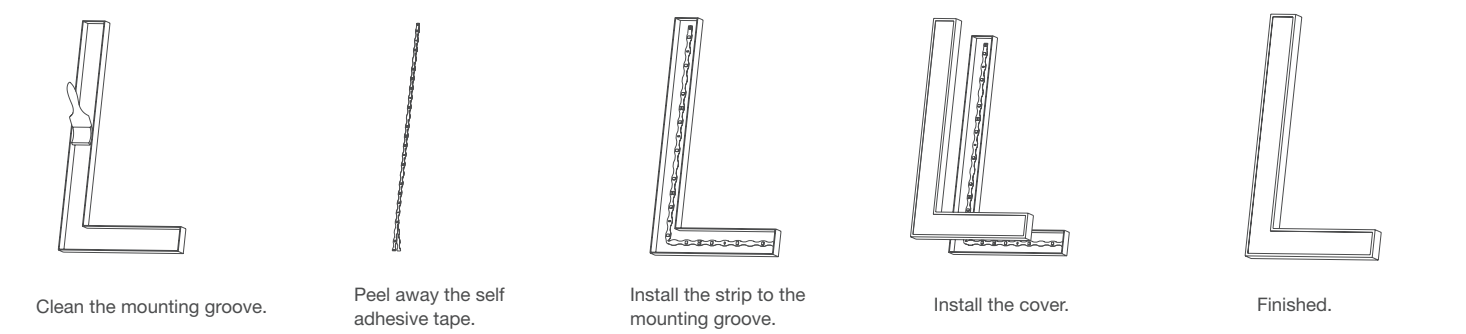

Warning Mark

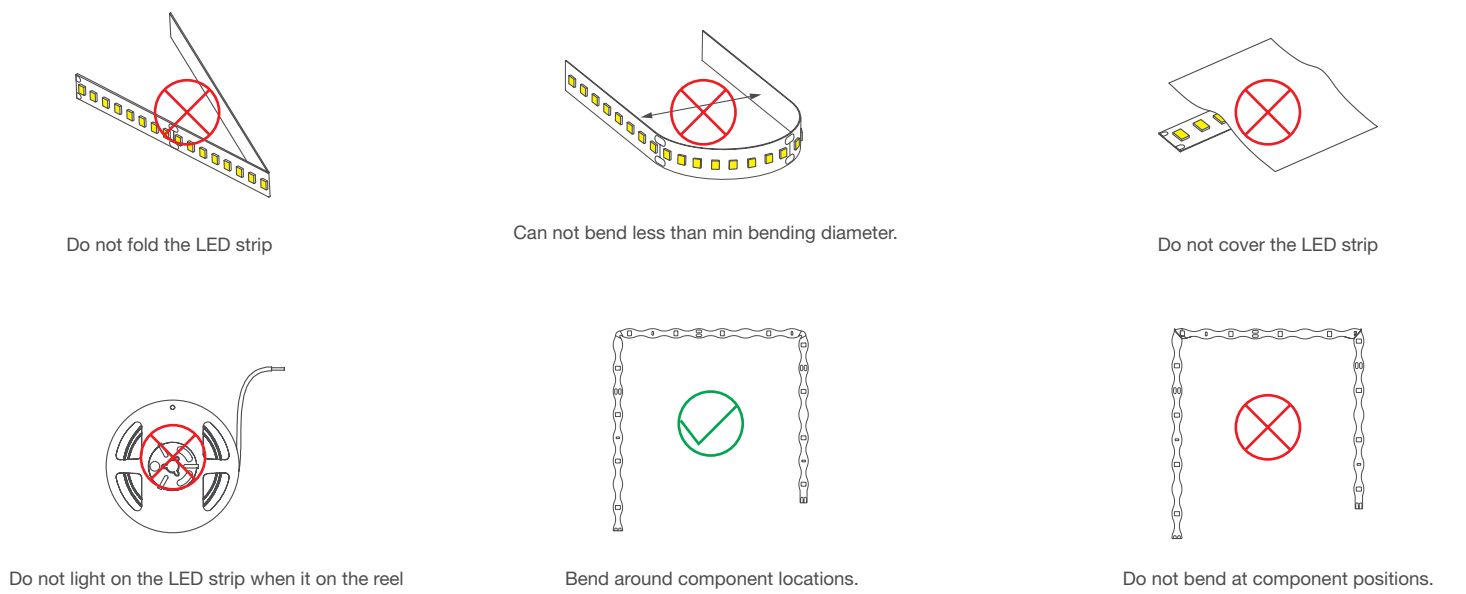

ATTENTIONS BEFORE INSTALLATION

- Before installation, please check whether the parameters of the product are consistent with the requirements (Seeing the Product Specification or Label).
- The voltage, current, and power of the power supply and load used must be consistent with this product.
- Follow the instructions of wiring diagram (first connect the load and then the power supply) to avoid short circuit.
- Product wires must be correctly connected to the positive and negative terminals of the power output, otherwise the light will not turn on.
- The power cord should be tightly screwed into the terminal, with a recommended tightness that cannot be pulled out by hand.
- The connection terminals must be effectively waterproof and corrosion-resistant.
- **If the installation length exceeds the maximum run length, extra power feed is needed.**
- **Auxiliary heat dissipation appliances must be added when the current of single LED exceeds regular value.**

WARNING

- Do not disassemble or retrofit the light. Do not touch the surface of the light with a sharp object.
- Do not do live-line working during installation,especially for high voltage product.
- Do not use any organic chemical solvents.
- Use neutral glass adhesive to fix this product and it needs to be dried 4 hours in the open environment after operation.
- Treat the ends and the circuit connection points that are not connected to the main line with insulation,waterproof, and anti-corrosion in the installation.
- Use 18AWG (0.75mm² cross-sectional area) or thicker core wire to avoid adverse consequences caused by overheating, if the power cable need to lengthen.
- Make sure the input voltage meets the requirements and lines are connected correctly before lighting on.
- This product is for signage, and do not use as general lighting.
- Series connection within the max run.
- The length of the power cable between the power supply and the led strip should not exceed 2 meters.Otherwise, large circuit loss will lead to inconsistent brightness.
- Installation, maintenance and repair should be operated by a qualified technician.

Version	Content	Date
A1.1	Update: Warning Mark	2025-11-8

BLUEVIEW ELEC-OPTIC TECH CO.,LTD

- ☐ Tel: +86-28-8148 0011
- ☐ Web.: [www.blueviewled.com](http://www.blueviewled.com)
- ☐ Fax: +86-28-8148 1258
- ☐ Email: [sales@blueviewled.com](mailto:sales@blueviewled.com)
- ☐ Add.: No. 1000, Section 2, Konggang 2nd Road, Shuangliu, Chengdu 610207, Sichuan, CHINA