



ChipBrand



One BIN only
for a CCT range



Lifetime



Certified



Certified



Warranty



Certified



Ra Available

IP Grade Available



Features

- 130LM/W Light Efficacy
- Constant Voltage 24 VDC system
- Silicone extruded-IP68, Silicone coated-IP65, indoor-IP22 available
- Epistar chips, LM80 tested
- Ra90+/80+
- CE and RoHS certified
- 5 years warranty







BLUEVIEW ELEC-OPTIC TECH CO.,LTD

Tel: +86-28-8148 0011 Fax: +86-28-8148 1258
 Mail: sales@blueviewled.com Web.: www.blueviewled.com
 Add: No.1000, Section 2, 2nd Konggang Road, Southwest
 Aviation Industrial Development Zone, Chengdu,Sichuan, China.
 Zip code: 610207

Specifications are subject to change without notice.
 ©Blueview™ 2016 – All rights reserved. Made in China.

Specifications

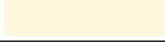
LED Type	SMD 2835	Dimmable	Yes (compatible with BV311 RF dimmer & BV Dimmer)
LED Q'ty/m	288pcs	IP grade	IP22 (IP65 & IP67 & IP68 available upon request)
Input Voltage	24V DC Constant Voltage	Installation	Heat-conductive adhesive tape (Heat sink is necessary)
Power	25.92W/m	Working Temperature	-25~+60°C
Cutting length	83.3mm, 24 LEDs	Max run	5 meters (Single Feed)
Strip Width	22mm	Certification	CE, RoHS
Viewing Angle	120°	Warranty	5 years

Order Code	CCT/Color	Ra	Lumen/M ^②
FN-H2835-288-24-27K	 2645-2805K	90+,80+	3600~4147
FN-H2835-288-24-29K	 2855-3025K	90+,80+	
FN-H2835-288-24-34K	 3265-3535K	90+,80+	
FN-H2835-288-24-42K	 3897-4223K	90+,80+	
FN-H2835-288-24-51K	 4900-5300K	90+,80+	
FN-H2835-288-24-57K	 5477-6020K	90+,80+	
FN-H2835-288-24-63K	 6020-6530K	90+,80+	
FN-H2835-288-24-65K	 6175-6825K	90+,80+	

Note^①: Contact Blueview for exact warranty period and policy

Note^②: Lumen output are based on CRI80+ measured according to PMS-80, with a tolerance of +/- 5%

Note^③: Standard package: 5m/roll

Order Code

Model	Quality level	LED Q'ty/M	Input voltage	CCT/Color
FN	H2835	288	24	27K
FN-IP22	H2835-5 yrs warranty		24V DC	view table above for options
FWS-IP65				
FWT-IP67				
FWE-IP68				

BLUEVIEW ELEC-OPTIC TECH CO.,LTD

Tel: +86-28-8148 0011 Fax: +86-28-8148 1258
 Mail: sales@blueviewled.com Web.: www.blueviewled.com
 Add: No.1000, Section 2, 2nd Konggang Road, Southwest
 Aviation Industrial Development Zone, Chengdu, Sichuan, China.
 Zip code: 610207

Specifications are subject to change without notice.
 ©Blueview™ 2016 – All rights reserved. Made in China.

Dimension //

Unit:mm[in]

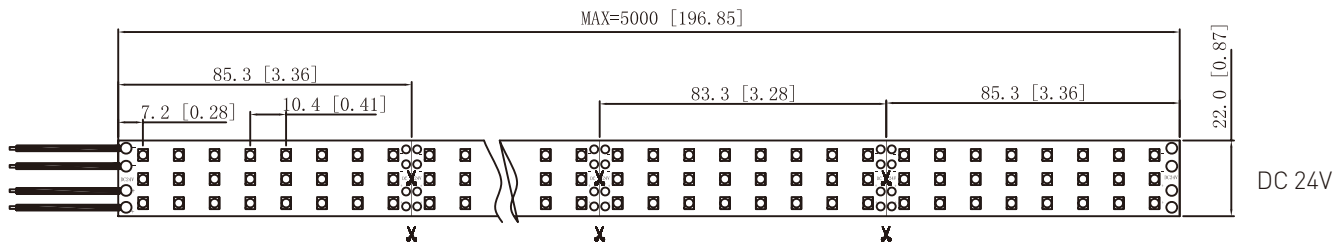

Package //

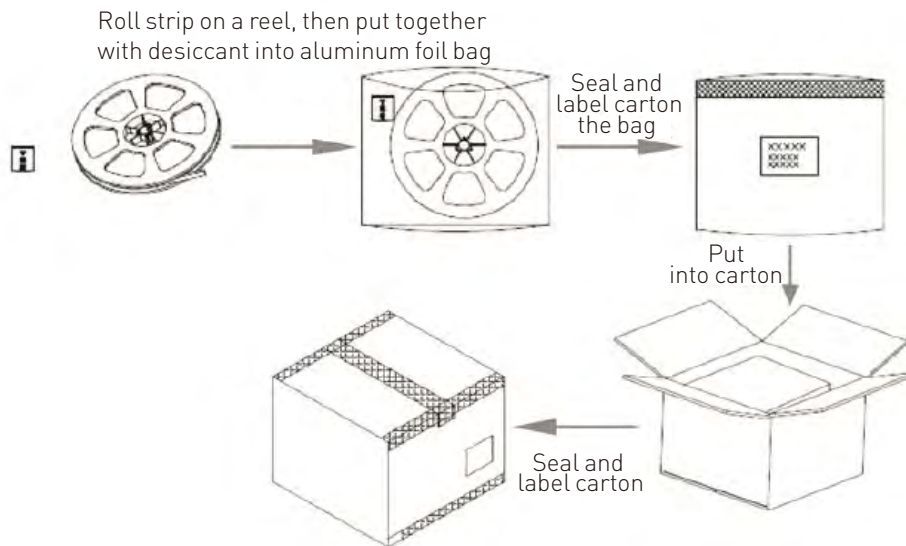

Packing Info

Order Code	Net Weight / CTN	Gross Weight / CTN	Units / CTN	Carton Size
FN-H2835-288-24	15.94(1±10%) kgs	16.25 (1±10%) kgs	50 rolls	550*400*340mm

BLUEVIEW ELEC-OPTIC TECH CO.,LTD

Tel: +86-28-8148 0011 Fax: +86-28-8148 1258
 Mail: sales@blueviewled.com Web.: www.blueviewled.com
 Add: No.1000, Section 2, 2nd Konggang Road, Southwest
 Aviation Industrial Development Zone, Chengdu,Sichuan, China.
 Zip code: 610207

Specifications are subject to change without notice.
 ©Blueview™ 2016 – All rights reserved. Made in China.