

Features

- High density and better linear effect for high brightness
- Small size with great flexibility, easy mounted in curved surface
- Cuttable every 62.5mm [2.46in] for various application
- Long lifespan with great lumen maintenance
- Create rich color effects via controller

Bending radius: Rmin=20mm



Application

- Signage, lightbox, artware, path illumination etc. with small size.

Installation

- Fix by 3M self adhesive tape

Optical & Electrical Parameters

Model No.	Light Color	Color Temperature/ Wavelength(K/nm)	Beam Angle	Ra	Typical Luminous Flux(lm/m)	Efficacy (lm/w)	Voltage (DC V)	Power (W/m)
TN-2110-384 -24-RGBW	R	620-625	120°	--	48	12.5	24	3.84
	G	460-470		--	330	17.7		3.84
	B	515-520		--	68	86		3.84
	R+G+B	100000		--	435	38		11.52
	W	3000		90+	343	89		3.84
	R+G+B+W	12000		70+	756	49		15.36

Other Parameters

Model No.	LED Quantity (pcs/m)	Standard Packing Length L*W(mm)	Max Run (Single Feed)(m)	Min Cuttable length(mm)	Working Temperature	Storage Temperature
TN-2110-384-24-RGBW	384	5000*10	3.0	62.5	-20~+60°C	-20~+70°C

NOTE:

- Test environment temperature : 25±2°C.
- The above data is typical values. The actual data of each single product may differ from the typical values. The data is subject to change without notice.
- The luminous flux is tested with single light on.
- Different color temperature will make luminous flux different.
- Power tolerance: ±10%.

Profile Drawings

Unit:mm

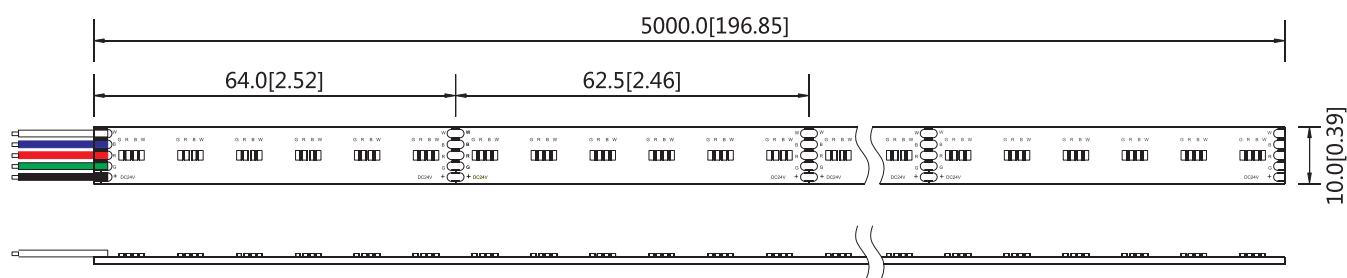

Note: Feel free to contact your sales for detailed drawings.

Working Length vs. Attenuation

Model No.	TN-2110-384-24-RGBW				
Working Length(m)	1	3	5	8	10
Head Voltage(DC V)	23.94	23.85	23.75	23.72	23.68
Tail Voltage(DC V)	23.71	22.17	19.65	17.71	16.66
Voltage Attenuation Rate(%)	0.96	7.04	17.26	25.34	29.65
Head Current (mA)	40.92	40.91	35.32	40.46	40.34
Tail Current (mA)	39.81	32.83	21.23	13.43	9.43
Current Attenuation Rate(%)	2.71	19.75	39.89	66.81	76.62
Working Power (W)	15.36	42.48	44.88	68.16	72.24
Recommended Power Supply Configuration(W)	18	50	55	85	90
Power Supply Mode	Single Feed				

Luminous Intensity Distribution Diagram

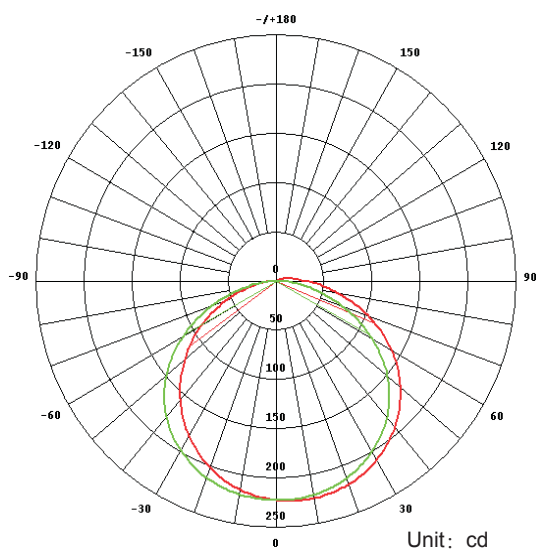

AVERAGE BEAM ANGLE(50%): 121.2°

— C0/180, 121.2°
— C90/270, 121.2°

Average Illumination

Flux Out: 551.2lm (CCT of white light: 3000K)

Height	Eavg, Emax	Beam Angle: 120.64°	Diameter
10cm	5391, 22380lx		35.09cm
20cm	1348, 5595lx		70.18cm
30cm	599.0, 2487lx		105.27cm
40cm	336.9, 1399lx		140.36cm
50cm	215.6, 895.2lx		175.45cm
60cm	149.8, 621.7lx		210.53cm
70cm	110.0, 456.7lx		245.62cm
80cm	84.24, 349.7lx		280.71cm
90cm	66.56, 276.3lx		315.80cm
100cm	53.91, 223.8lx		350.89cm

Note: the above two figures are tested with the sample TN-2210-384-24-RGBW and with 4 lights normally on.
Welcome to contact with the sales for more product info.

packing

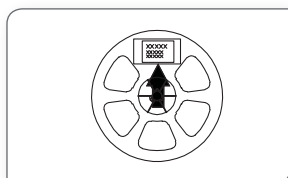

Label the reel;

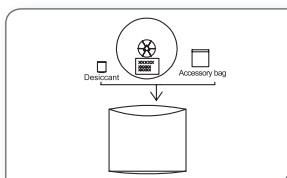

Put reel, accessory bag and desiccant together into static shielding bag;

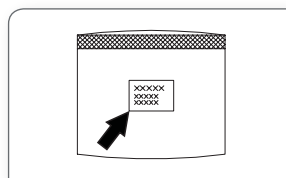

Seal and label the static shielding bag;

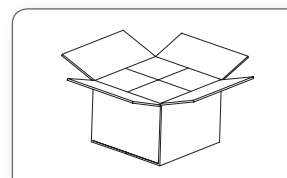

Put the packed static shielding bag into carton box;

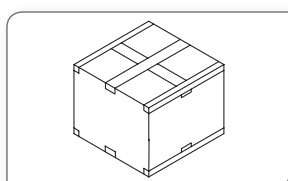

Seal the carton box;

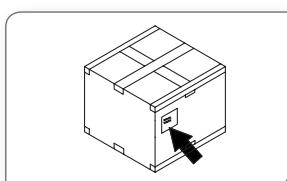

Label the box;

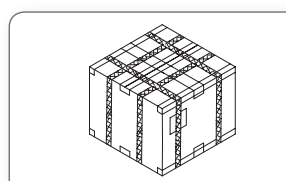

Use packing belt to pack. Add edge protectors if necessary.

Packaging information

Model No.	Product Size L*W	Carton Size	Meter/Reel	Reel/Carton	Net Weight(kg)	Gross Weight(kg)
TN-2110N-384-24-RGBW	5000*10mm	550*400*340mm	5	100	9.55(1±10%)	13.15(1±10%)

Note:

- Five meters per reel, packed in the static shielding bag.
- The above quantity and weight are only for the illustrated packaging method.
- There will be differences in the quantity and weight with other packaging methods.

Installation

1.Products and Tools

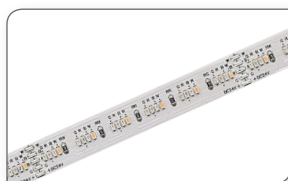

TN-2110-384-24-RGBW

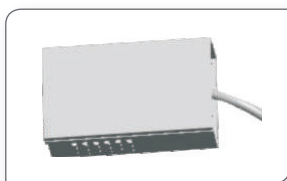

LED power supply



Self-tapping screw



Insulation Tape



Clips



Electric iron



Diagonal pliers

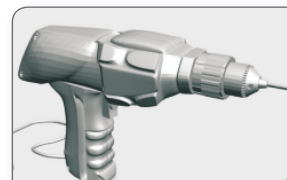

Electric drill

2.Installation Methods and Steps

Aluminum channel installation

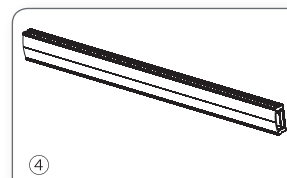
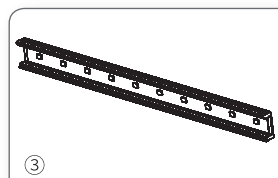
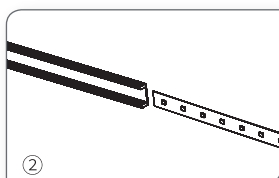
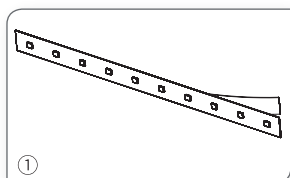

1. Peel away the self adhesive tape on the back of strip.
2. Cut off the excess part based on the installation position.
3. Evenly arrange the strips with appropriate space in the track.
4. Install the cover and end cap.

Covered channel installation

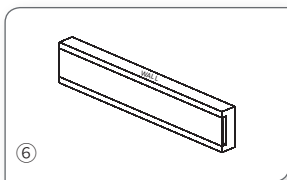
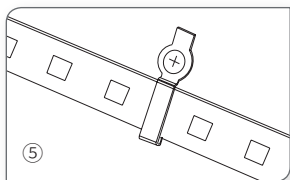
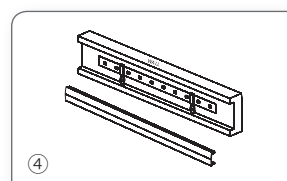
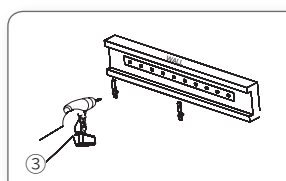
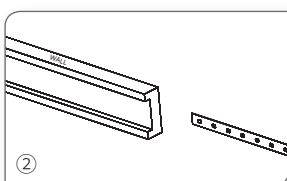
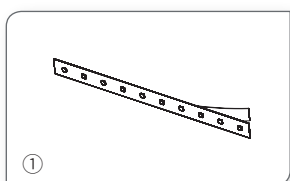

1. Peel away the self adhesive tape on the back of strip.
2. Cut off the excess part based on the installation position.
3. Evenly arrange the strips with appropriate space in the track and fix them with clips.
4. Install the cover and end cap.
5. Clip installation as the figure show
6. Finished

Attentions

- Before installation, check that the product parameters are consistent with the requirements (Seeing product specifications or product labels)
- Load voltage, current, power and power supply should be matched with the product.
- Follow the instructions of wiring diagram (first connect the product and then the power supply) to avoid short circuit.
- Make sure the correct connection of positive and negative poles between the product and power supply. Otherwise, the light will not be on.
- Make sure the power cord firmly screwed into the terminal and it should not be pulled out by hands.
- The terminal should have insulation, waterproof and anti-corrosive treatment.
- If the working length exceeded the max run length, make sure to have extra power supply.
- If it needs higher current of a LED, make sure having extra cooling.

Common Faults and Troubleshoot

Quick Guide		
Problems	Reasons	Solutions
All LEDs can not light on.	No electric supply.	Fix the short circuit problem.
	Automatic power protection from the open or short circuit in output of the power supply.	Fix the short circuit problem.
	Wrong connection of power supply.	
LEDs can not light on partly.	Some switching mode power supplies are not powered.	Check the power supply system to fix it.
	Power supply line error.	
	Mistaken wire connection of some of products	Correctly connection
Brightness of LED is inconsistent for insufficient.	Power overloaded.	Replace with more powerful power
	Power supply circuit excessive consumption.	Make sure the working voltage of the product within $\pm 5\%$ of standard voltage, or keep balance by circuit power consumption.
	Excessive quantities in series connection of the product	Reduce the quantities of the product in series connection to meet requirement.
LED flicker.	Connection point fault.	Remove bad connection point.
	Switching power supply failure.	Replace a new power supply.
	Wrong Installation or use of products	Please follow the instructions

Warning

- Do not disassemble or retrofit the light. Do not touch the surface of the light with a sharp object.
- Do not do live-line working during installation, especially for high voltage product.
- Do not use any organic chemical solvents.
- Use neutral glass adhesive to fix this product and it needs to be dried 4 hours in the open environment after operation.
- Treat the ends and the circuit connection points that are not connected to the main line with insulation, waterproof, and anti-corrosion in the installation.
- Use 18AWG (0.75mm² cross-sectional area) or thicker core wire to avoid adverse consequences caused by overheating, if the power cable need to lengthen.
- Make sure the input voltage meets the requirements and lines are connected correctly before lighting on.
- The product is for signage, please do not use as general lighting.
- Series connection within the max run.
- The length of the power cable between the power supply and the led strip should not exceed 2 meters. Otherwise, large circuit loss will lead to inconsistent brightness.
- Installation, maintenance and repair should be operated by a qualified technician.

Statements and Recycling

Statements:

- Repair should be operated by a qualified technician, if the external circuit or main line of this product is damaged.
- The parameters given in this manual are typical values and for reference only.
- All illustrations and drawings in this manual are for reference.
- This product is subject to change without notice.

Recycling:

- LED lighting products belongs to electronic products, please do recycling treatment according to the relevant WEEE directives.